



CELESTYAL

Every journey tells a story

CRUISE ITINERARIES 2025

GREECE AND THE MEDITERRANEAN



IDYLIC AEGEAN

7 night Inclusive cruise
onboard *Celestyal Journey*

ATHENS | THESSALONIKI
KUSADASI | CRETE (HERAKLION)
SANTORINI | MYKONOS
MILOS | ATHENS



Thessaloniki

Embarkation
Ports

Athens

Mykonos

Kusadasi

Milos

Santorini

Heraklion

YOUR ITINERARY

DAY	PORTS	ARRIVE	DEPART
Saturday	Athens (Piraeus) Greece		17:00
Sunday	Thessaloniki Greece	10:00	19:00
Monday	Kusadasi (Ephesus) Turkey	13:00	19:00
Tuesday	Crete (Heraklion) Greece	08:00	18:00
Wednesday	Santorini* Greece	07:00	
Thursday	Santorini* Greece		00:30
Thursday	Mykonos* Greece	08:00	
Friday	Mykonos* Greece		02:00
Friday	Milos* Greece	09:00	19:00
Saturday	Athens (Piraeus) Greece	07:00	

2025 SAILING DATES

May	24, 31
June	07, 14, 21, 28
July	05, 12, 19, 26
August	02, 09, 16, 23, 30
September	06, 13, 20, 27
October	04, 11, 18, 25

* Tendering weather permitting.
Why not start your cruise in Thessaloniki, Kusadasi or Heraklion.



ECLECTIC AEGEAN

7 night Inclusive cruise
onboard *Celestyal Journey*

ATHENS | ISTANBUL
MYKONOS | KUSADASI
RHODES | SANTORINI
ATHENS



YOUR ITINERARY

DAY	PORTS	ARRIVE	DEPART
Saturday	Athens (Piraeus) Greece		16:00
Sunday	Istanbul Turkey	16:00	
Monday	Istanbul Turkey		18:00
Tuesday	Mykonos* Greece	14:30	
Wednesday	Mykonos* Greece		01:00
Wednesday	Kusadasi (Ephesus) Greece	08:00	18:00
Thursday	Rhodes Greece	07:30	18:00
Friday	Santorini* Greece	06:30	21:00
Saturday	Athens (Piraeus) Greece	07:00	

2025 SAILING DATES

March 29
April 05, 12, 19

* Tendering weather permitting.
Cruises can also start in Istanbul.



THREE CONTINENTS

7 night Inclusive cruise onboard *Celestyal Journey*

ATHENS | PORT SAID
ASHDOD | LIMASSOL
RHODES | KUSADASI
ATHENS



YOUR ITINERARY

DAY	PORTS	ARRIVE	DEPART
Saturday	Athens (Piraeus) Greece		17:00
Sunday	At sea		
Monday	Cairo (Port Said) Egypt	06:30	22:00
Tuesday	Ashdod Israel	08:00	22:00
Wednesday	Limassol Cyprus	11:00	18:00
Thursday	Rhodes Greece	12:00	18:30
Friday	Kusadasi (Ephesus) Turkey	07:00	17:00
Saturday	Athens (Piraeus) Greece	07:00	

2025 SAILING DATES

March 01, 08, 15, 22
November 01, 08, 15, 22, 29
December 06, 13, 20, 27

Why not start your cruise in Limassol.



HEAVENLY ADRIATIC

7 night Inclusive cruise
onboard *Celestyal Journey*

ATHENS | KEFALONIA
DUBROVNIK | KOTOR | CORFU
KATAKOLO | SANTORINI
ATHENS

YOUR ITINERARY

DAY	PORTS	ARRIVE	DEPART
Saturday	Athens (Piraeus) Greece		13:00
Sunday	Kefalonia Greece	08:00	17:00
Monday	Dubrovnik Croatia	12:00	
Tuesday	Dubrovnik Croatia		02:30
Tuesday	Kotor Montenegro	08:00	17:00
Wednesday	Corfu Greece	10:00	18:00
Thursday	Katakolo Greece	07:00	15:00
Friday	Santorini Greece	08:00	21:00
Saturday	Athens (Piraeus) Greece	07:00	

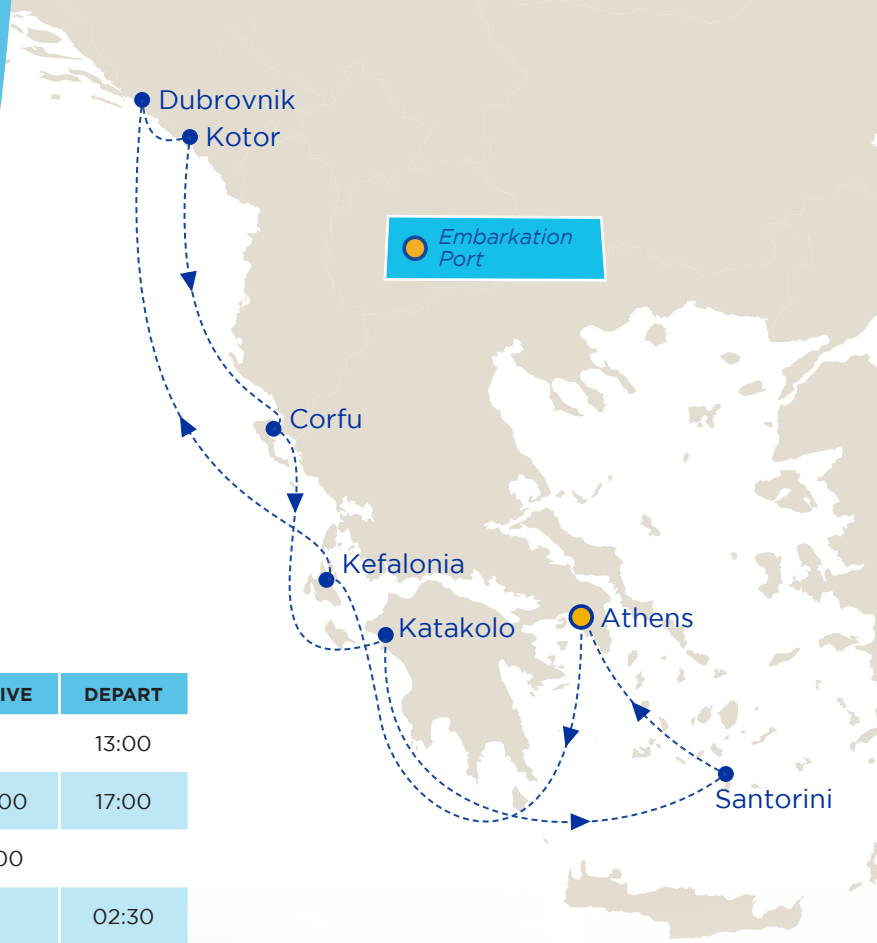

2025 SAILING DATES

April 26
May 03, 10, 17



ICONIC AEGEAN (MAR & NOV)

3 night Inclusive cruise
onboard *Celestyal Olympia*

ATHENS | MYKONOS
KUSADASI | PATMOS
SANTORINI | ATHENS



YOUR ITINERARY

DAY	PORTS	ARRIVE	DEPART
Friday	Athens (Piraeus) Greece		11:00
Friday	Mykonos* Greece	17:00	23:00
Saturday	Kusadasi (Ephesus) Turkey	07:00	12:30
Saturday	Patmos* Greece	16:00	21:00
Sunday	Santorini* Greece	07:00	20:00
Monday	Athens (Piraeus) Greece	07:00	

2025 SAILING DATES

March 21, 28
October 31
November 07, 14

* Tendering weather permitting.
Why not start your cruise in Kusadasi.



ICONIC AEGEAN (MAR - OCT)

3 night Inclusive cruise
onboard *Celestial Olympia*

ATHENS | MYKONOS | KUSADASI
PATMOS | CRETE (HERAKLION)
SANTORINI | ATHENS



YOUR ITINERARY

DAY	PORTS	ARRIVE	DEPART
Friday	Athens (Piraeus) Greece		12:00
Friday	Mykonos* Greece	18:00	23:00
Saturday	Kusadasi (Ephesus) Turkey	07:00	13:00
Saturday	Patmos* Greece	16:30	21:30
Sunday	Crete (Heraklion) Greece	07:00	12:00
Sunday	Santorini* Greece	16:30	21:30
Monday	Athens (Piraeus) Greece	07:00	

2025 SAILING DATES

April	04, 11, 18, 25
May	02, 09, 16, 23, 30
June	06, 13, 20, 27
July	04, 11, 18, 25
August	01, 08, 15, 22, 29
September	05, 12, 19, 26
October	03, 10, 17, 24

* Tendering weather permitting.
Why not start your cruise in Kusadasi.



ICONIC AEGEAN (MAR, OCT & NOV)

4 night Inclusive cruise
onboard *Celestyal Olympia*

ATHENS | MYKONOS
KUSADASI | PATMOS
RHODES | SANTORINI
ATHENS



YOUR ITINERARY

DAY	PORTS	ARRIVE	DEPART
Monday	Athens (Piraeus) Greece		11:00
Monday	Mykonos* Greece	17:00	23:00
Tuesday	Kusadasi (Ephesus) Turkey	07:00	12:30
Tuesday	Patmos* Greece	16:00	21:00
Wednesday	Rhodes Greece	07:00	18:00
Thursday	Santorini* Greece	07:00	20:00
Friday	Athens (Piraeus) Greece	07:00	

2025 SAILING DATES

March 24
October 27
November 03, 10

* Tendering weather permitting.
Why not start your cruise in Kusadasi.



ICONIC AEGEAN (MAR - OCT)

4 night Inclusive cruise
onboard *Celestial Olympia*

ATHENS | MYKONOS
KUSADASI | PATMOS | RHODES
| CRETE (HERAKLION)
SANTORINI | ATHENS



YOUR ITINERARY

DAY	PORTS	ARRIVE	DEPART
Monday	Athens (Piraeus) Greece		12:00
Monday	Mykonos* Greece	18:00	23:00
Tuesday	Kusadasi (Ephesus) Turkey	07:00	13:00
Tuesday	Patmos* Greece	16:30	21:30
Wednesday	Rhodes Greece	07:00	18:00
Thursday	Crete (Heraklion) Greece	07:00	12:00
Thursday	Santorini* Greece	16:30	21:30
Friday	Athens (Piraeus) Greece	07:00	

2025 SAILING DATES

March	31
April	07, 14, 21, 28
May	05, 12, 19, 26
June	02, 09, 16, 23, 30
July	07, 14, 21, 28
August	04, 11, 18, 25
September	01, 08, 15, 22, 29
October	06, 13, 20

* Tendering weather permitting.
Why not start your cruise in Kusadasi.



YOUR SHIP CELESTYAL JOURNEY

A STAR IS BORN. THE CELESTYAL JOURNEY.

Every constellation has a brightest star. And the planets have aligned to reveal ours, as we officially welcome the starry-eyed Celestyal Journey - our brand-new ship that's destined to light up the seas.

Celestyal Journey is our most luxurious ship yet, transporting us around the wonders of Greece and the glittering waters of the Eastern Mediterranean in style. When it comes to making award-winning voyages come true, we spare no expense. The 1,260 guest cruise liner has undergone a €20 million refurbishment with our sights set on one thing only - a guest experience worthy of the gods. Step onboard Celestyal Journey and discover a truly special cruise experience.

TAKE WELLNESS TO A NEW LEVEL

Celestyal Journey takes Mediterranean-style R&R into the stratosphere with The Sozo Experience. Inspired by the Greek tradition of wellness, our new deck is ready to strengthen and soothe your mind, body, and spirit. The all-new Sozo Spa goes more than skin deep, rejuvenating bodies and recharging chakras with a Dream Den relaxation area, a new indulgent Glow Bar for pampering treats and panoramic sea views.

Work out the new fitness area with all the equipment you need - from cardio to weights and a dedicated fitness instructor. Cool off before the evening entertainment with open-air exercise on the tennis and basketball courts or take in the views on our outdoor jogging track.

SLEEP CLOSER TO THE STARS

For the first time ever, we're proud to bring you the Stargazer Suite - a penthouse suite with a private terrace made for special moments. And our 148 Dream Suites offer far more than just a place to sleep; they are designed as a sanctuary to restore your sense of magic as you drift off to the tranquil rhythms of the Aegean Sea in supreme comfort, while our 120 Junior Dream Suites and 28 Grand Dream Suites offer cozy escapes and quiet moments, all with balconies.

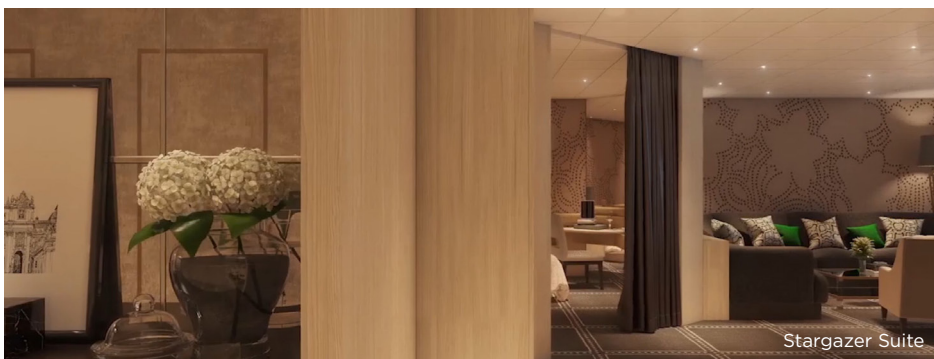

All Dream Suite guests can enjoy exclusive access to The Beach Club, a secluded and tranquil outdoor space, with ice cream stations and juice corners. And guests staying in the Grand Dream Suites will indulge in an extra touch of Celestyal Journey magic with our Concierge Service. From special occasions to bespoke requests, guests can expect a dedicated priority check-in counter, expedited embarkation and express luggage delivery service – we'll even help you unpack.

HEAVENLY DINING

Our seven new restaurants keep your senses refreshed and tantalized every time. Enjoy full star treatment with a private dining experience at our new exclusive Chef's Table. Or wander further afield to Pink Moon, an exquisite Asian-inspired restaurant designed to give your taste buds a true zen treatment. Find fresh Mediterranean bites at our new Smoked Olive restaurant or enjoy daytime Greek grazing in Fig & Honey before an evening of moonlit dining in Thalassa.

EXPERIENCE THE FIZZ OF UNFORGETTABLE ENTERTAINMENT

Sip and stargaze in one of our eight glittering new bars. Slide into the Blue Bar & Lounge, where mellow piano tunes and laid-back lounging will take you to new levels of go-with-the-flow. Or pick up the pace in our new Fizz Club, where Signature Cocktails and fresh ingredients plucked straight from the islands will have you all aflutter. And with spellbinding and spectacular shows and entertainment to see you through the evening, there's plenty to see you into the early hours.

ONBOARD SERVICES

Our onboard staff welcomes you with open arms. Whatever your needs, our dedicated teams are ready to make your Celestyal experience even more special. Our tax-free shop is the perfect place to add a shimmering touch to your outfit or to find a memorable souvenir to take home with you. Need to entertain in style? Celestyal Journey comes with Wi-Fi included and features two fully equipped conference rooms, which along with its multi-purpose Amphitheatero make her the perfect choice for meetings and incentives.



YOUR SHIP CELESTYAL OLYMPIA

The elegant Olympia reflects and celebrates Greek heritage, tradition and culture and offers warm Mediterranean hospitality. She has sunny, bright, airy lounges and restaurants, spacious staterooms, two pools and generous expanse of teak decking.

The ship is named after the site in Western Greece, dedicated to Zeus, where the ancient Olympic Games were held.

Regarded as the jewel in the crown of the Celestyal fleet, Olympia underwent a complete refurbishment in 2016 and is home to a maximum of 1,664 guests on any one cruise being looked after by a crew of just over 540.

Your time on board will seem unhurried and relaxed and there will be plenty of time to explore the exciting places Olympia will take you to.

SUITES AND STATEROOMS

The Olympia has 694 staterooms and 30 Suites. 9 of these are with private balconies. All suites and staterooms are en-suite, with, TV and have air conditioning. All suites have minibars.

RESTAURANTS

Dining options range from the Aura Grill or the Leda Buffet for casual dining on deck nine and the Aegean Restaurant which offers Mediterranean and international cuisine. You can enjoy lobster and Mediterranean fish in the Specialty Restaurant.



Interior Stateroom



Outside Stateroom



Junior Suite

BARS

Venues to relax and meet up include Horizons Lounge and Bar located up in the funnel of the ship offering a 360 degree view, Thalassa or Helios bars, the Eclipse Lounge and Bar on the Sports Deck and the Argo bar on deck 5.

ENTERTAINMENT & RELAXING

The Muses Lounge is the perfect place to sit back, relax and enjoy an evening show. There's a different style performance every night, from traditional Greek dancing to acrobatic displays. The Selene Lounge and Bar is the perfect place to party the night away. If you're feeling lucky, you can head along to the onboard casino where you will find classic games such as Roulette, Blackjack and Poker, along with the latest vegas-style slot machines. Or if you prefer a slightly slower pace, then why not relax in the onboard Spa. Enjoy a sauna, steamroom or indulge in one of the many treatments we have to offer. There are two swimming pools on deck 9.

ONBOARD SERVICES

On board your Celestyal Cruise you'll find professional photographers who are there to capture your special moments. We also have an array of shops selling traditional Greek products and tax-free goods. Wi-Fi is available for an additional charge.



Balcony Suite



ONBOARD CELESTYAL JOURNEY

SYMBOL LEGEND

- None 2 lower beds
- ▲ 3rd berth
- ★ Sofa bed
- Double sofa bed
- ▢ Double sofa bed with bunk bed
- ◆ Double bed (only in the Penthouse)
- ⊙ Shower
- ⊛ Jet tubs
- ⌒ Porthole
- * Wheelchair accessible
- ◁▷ Interconnecting rooms
- ⌒ Obstructed view

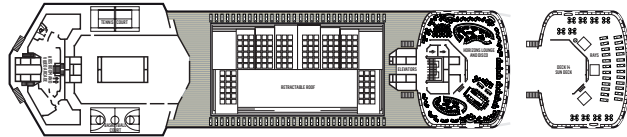

DECK 12/14

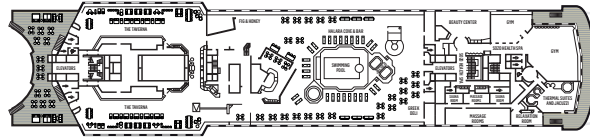

DECK 11

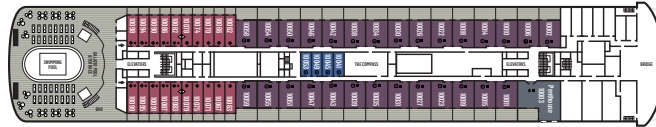

DECK 10

PLACES TO HAVE A GOOD MEAL

- Deck 11** The Taverna and Greek Deli
- Deck 8** Pink Moon Restaurant, The Smoked Olive Restaurant, Chef's Table and Grill Seekers Specialty Restaurant
- Deck 7** Thalassa Restaurant

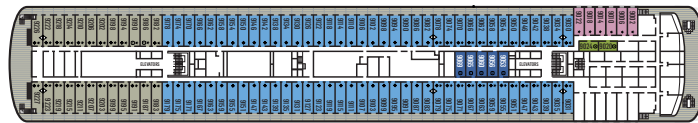

DECK 9

PLACES TO HAVE FUN

- Deck 12** Horizons Lounge and Disco
- Deck 8** Blue Bar and Lounge, Martini Piano Bar and Lounges, Ocean Bar and Lounge, Amphitheatre Show Lounge, Atrium, Casino
- Deck 7** Grapevine and Amphitheatre Show Lounge

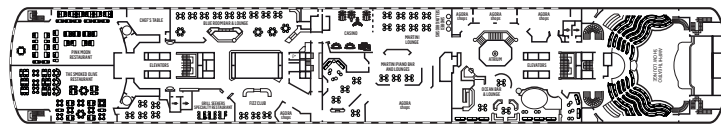

DECK 8

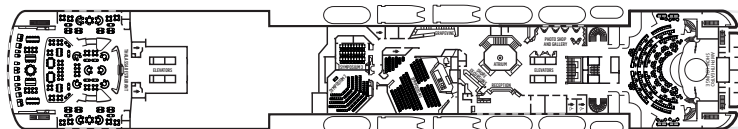

DECK 7

PLACES TO TREAT YOURSELF

- Deck 14** Sun Deck sunbathing area, Rays (suites only sunbathing and relaxing area)
- Deck 12** Sunbathing area, Kids Room and Video Arcade, Sports Activities (Tennis and Basketball Courts)
- Deck 11** Halara Cove, Swimming pool and Jacuzzis, Sunbathing area, Fig & Honey, Sozo Health Spa: Beauty Center, Gym, Thermal Suites and Jacuzzi, Sauna, Relaxation Room
- Deck 10** The Compass (Suites only lounge), Galazio Pool & Terrace, Bar and Sunbathing Area
- Deck 8** Agora Shops, Shore Excursions Selling Kiosks
- Deck 7** Photo Shop and Gallery, Symposium 1 - conference and cooking demonstration, Symposium 2 and 3 - conference areas, Shore Excursions, Reception and Atrium
- Deck 6** Walking around deck
- Deck 4** Medical Center

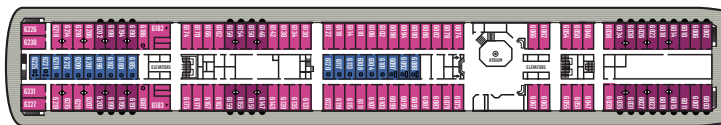

DECK 6



DECK 5

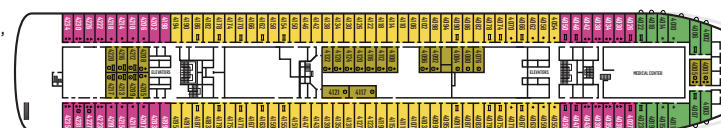

DECK 4

YOUR SHIP

- 1260 guests in 630 staterooms, 149 with private balcony
- All staterooms are equipped with telephone, hairdryers, safety deposit boxes & TV
- Wi-Fi and doctor on board at extra cost

Length 219,30 m
Tonnage 55,877 grt
Flag Bermuda

Deckplans and stateroom layouts are given purely as a guide. Size and layout may vary within the same category.

CATEGORY	DECK	DESCRIPTION	NUMBER OF STATEROOMS
INTERIOR COSMOS CABINS			
IA	4	2 lower beds, 1 upper bed, 1 single or double sofa with bunk beds, bathroom with shower	24
IB	5/9	2 lower beds, 1 upper bed, 1 single sofa, bathroom with shower	46
IC	5/6/9/10	2 lower beds, 1 upper bed, 1 single or double sofa with bunk beds, bathroom with shower	59
EXTERIOR COSMOS CABINS			
XA	4/5	2 lower beds, double bed sofa with bunk beds, bathroom with shower or bathtub	20
XBO	6	2 lower beds, bathroom with bathtub (obstructed view)	34
XB	4/6	2 lower beds, 1 upper bed, 1 single or double sofa with bunk beds, bathroom with shower or bathtub	104
XC	4/5	2 lower beds, 1 upper bed, 1 single or double sofa with bunk beds, bathroom with bathtub	98
XD	5/9	2 lower beds, 1 single or double sofa with bunk beds, bathroom with bathtub	96
DREAM SUITES			
SJA	9	2 lower beds, single sofa bed, bathroom with jet tubs or shower	24
SJB	9	2 lower beds, single sofa bed, bathroom with jet tubs	76
SJC	10	2 lower beds, single sofa bed, bathroom with jet tubs	20
SG	10	2 lower beds, double sofa bed, bathroom with shower	28
SP	10	1 double bed, double sofa bed, bathroom with shower and jacuzzi bathtub	1

ONBOARD CELESTYAL OLYMPIA

SYMBOL LEGEND

- None 2 lower beds
- Double bed
- 2 lower beds + 2 upper beds
- ★ Sofa bed
- ★○ Double bed + sofa + stateroom with bathtub
- * Suitable for wheelchair
- Stateroom with bathtub
- ▲ Stateroom with obstructed view

PLACES TO HAVE A GOOD MEAL

Deck 9 Aura Grill - Greek Deli - Leda Casual Dining

Deck 4 Aegean Restaurant - Specialty Restaurant

PLACES TO HAVE FUN

Deck 12 Horizons Lounge & Bar

Deck 10 Thalassa Bar

Deck 9 Helios Bar

Deck 7 Eclipse Lounge & Bar - Sports Deck

Deck 5 Muses Lounge & Bar - Argo Lounge & Bar - Casino - Selene Lounge & Bar

PLACES TO TREAT YOURSELF

Deck 9 Swimming Pools - Massage Cabana

Deck 8 Sauna - Massage Rooms - Gym

Deck 7 Kid's Club - Video Game Room

Deck 5 Photo Shop - Agora Shop - Beauty Center

Deck 4 Reception - Shore Excursions - Library - Duty Free Shop

Deck 1 Medical Center

YOUR SHIP

- 1,664 passengers in 724 staterooms, 9 with private balcony
- All staterooms are equipped with telephone, hairdryers, safety deposit boxes & TV
- Minibar in all suites
- Fully air-conditioned, stabilisers
- Wi-Fi and doctor on board at extra cost

Length 214.88 m

Tonnage 37,584 grt

Flag Malta

Deckplans and stateroom layouts are given purely as a guide. Size and layout may vary within the same category. Some staterooms in SJ category might have partially obstructed view.

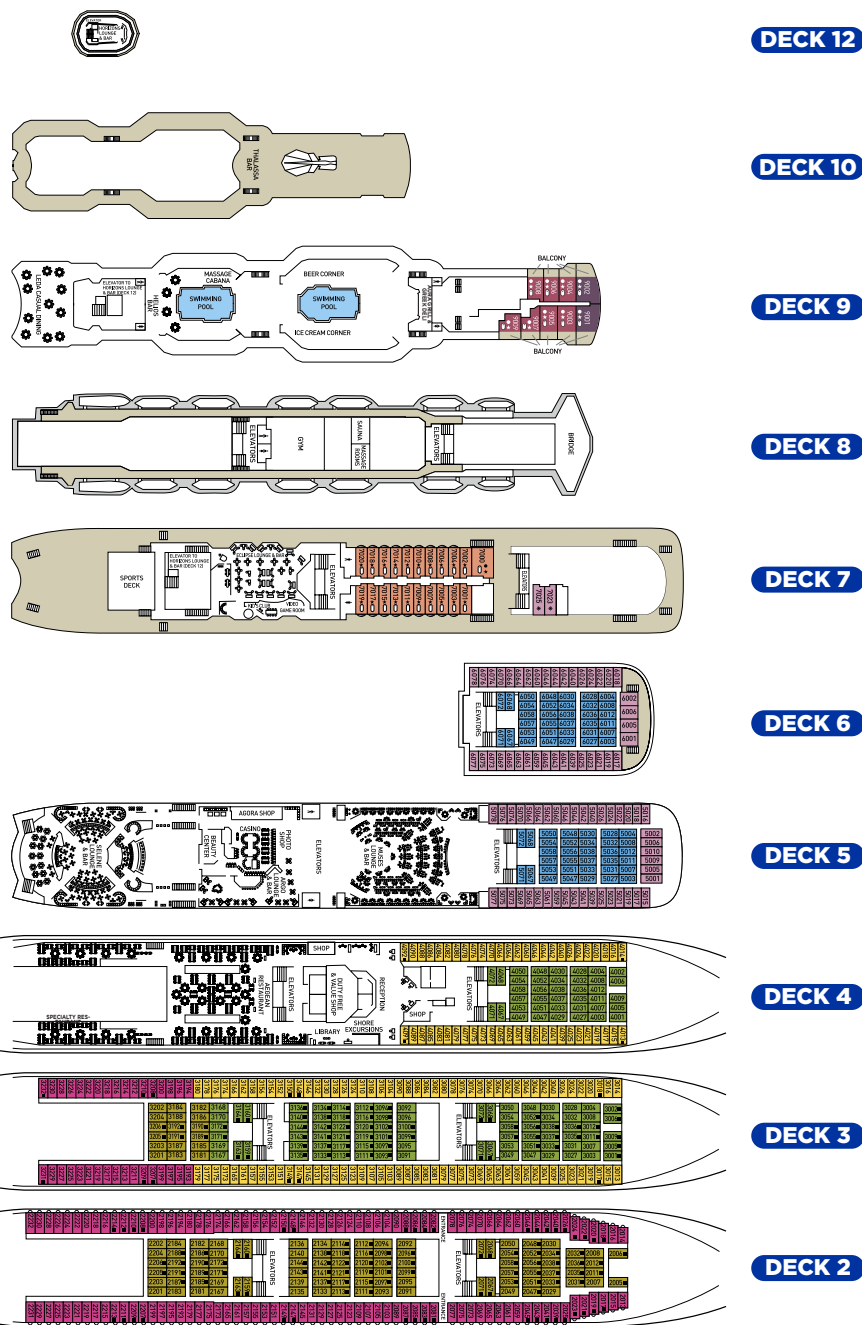

CATEGORY	DECK	DESCRIPTION	NUMBER OF STATEROOMS
INSIDE STATEROOM			
IA	2/3	2 lower beds, 3rd/4th berth, bathroom with shower	114
IB	3/4	2 lower beds, 3rd/4th berth, bathroom with shower	124
IC	5/6	2 lower beds, bathroom with shower	68
OUTSIDE STATEROOM			
XA	2/3	2 lower beds, 3rd/4th berth, bathroom with shower	160
XB	3/4	2 lower beds, 3rd/4th berth, bathroom with shower	146
XC	5/6	2 lower beds, bathroom with shower	82
SUITES			
SJ	7	Double bed, sofa bed, bathroom with bathtub	21
SB	9	Double bed, sofa bed, bathroom with bathtub, balcony	7
SG	9	Double bed, sofa bed, bathroom with bathtub and shower, balcony	2



CELESTYAL
Every journey tells a story



celestyal.com

